

# 2000 litre Grease Interceptor Trap (G.I.T.)

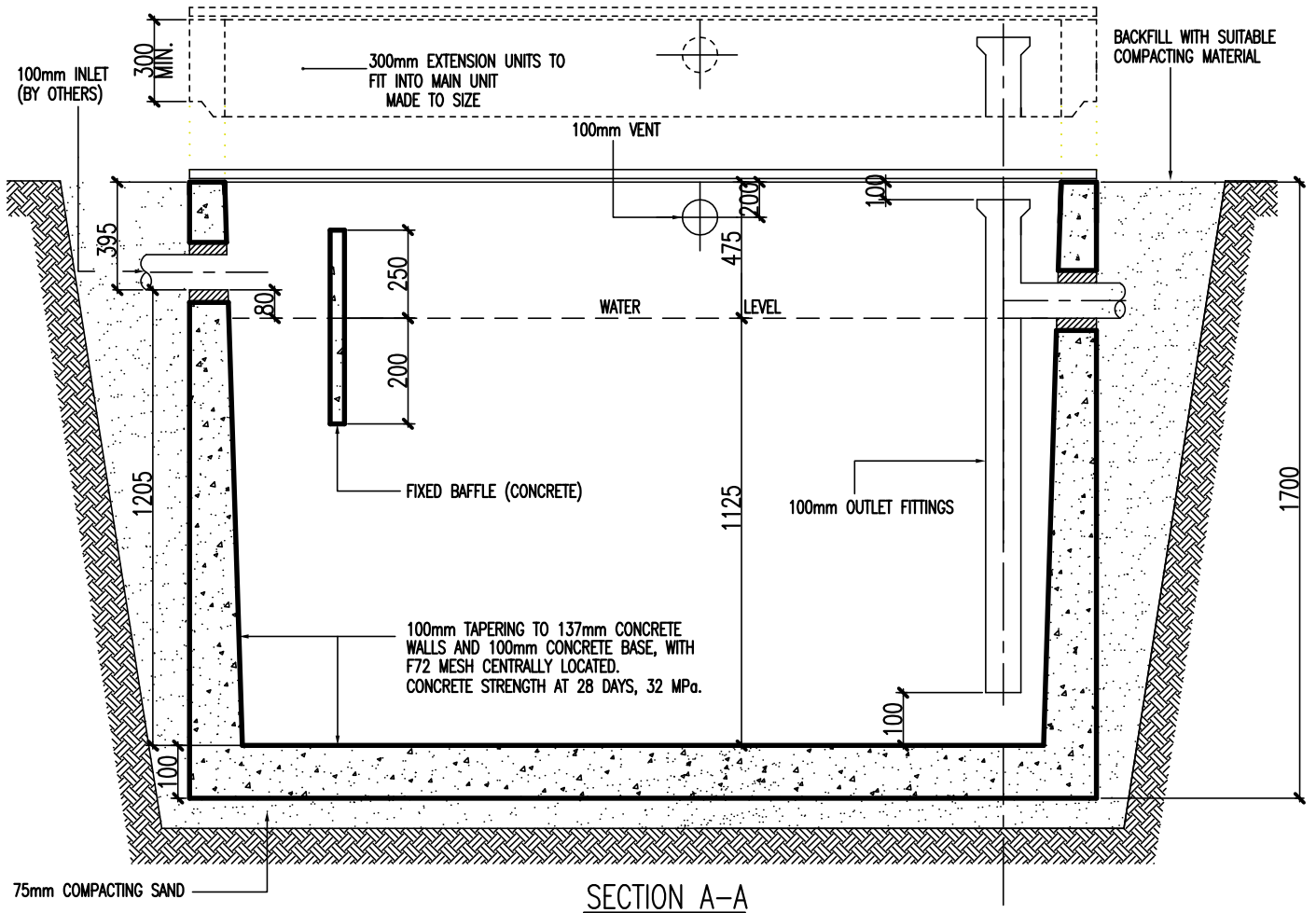

SECTION A-A

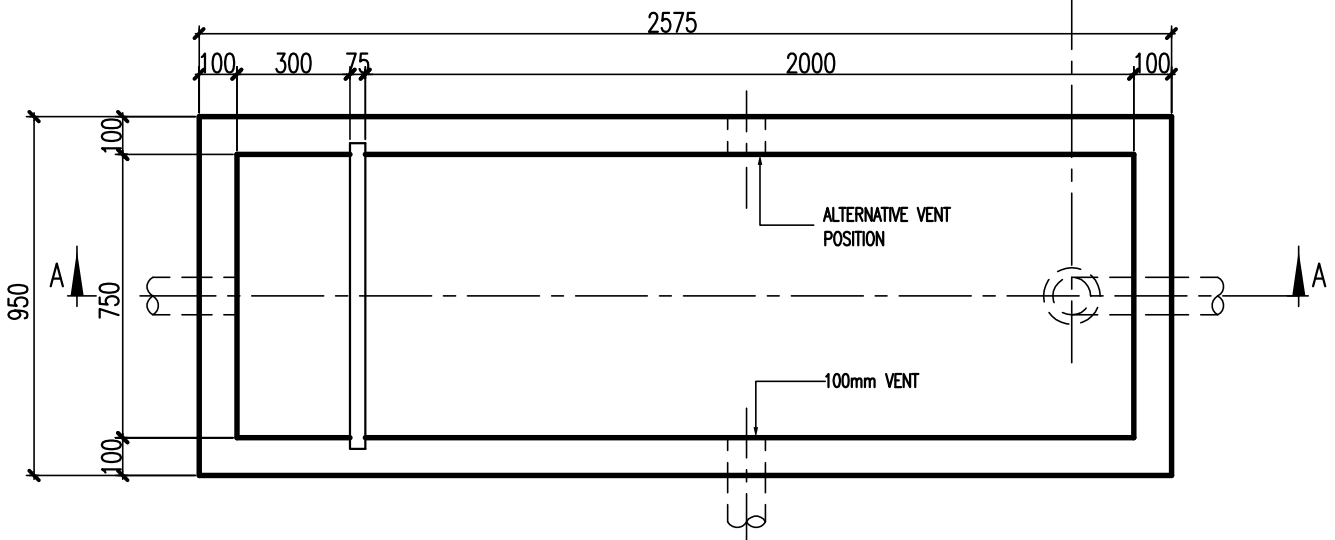

PLAN

NOTE :- EXTENSION RISERS MADE TO FIT INTO MAIN UNIT, TO EXACT DEPTH REQUIRED. MINIMUM HEIGHT 300mm  
COVERS CONSIST OF :-

LIGHT DUTY  
MEDIUM DUTY  
HEAVY DUTY

NOTE :- 0/ALL SIZE OF PIT :-

950 WIDE x 2575 LONG x 1700 DEEP

\* WEIGHT 3800 kg

\* INTERCEPTOR TO BE INSTALLED, CONNECTED, VENTED AND PROVIDED WITH COVERS IN ACCORDANCE WITH REQUIREMENTS OF LOCAL AUTHORITIES.

MELBOURNE WATER TYPE 9/1A

APPROVAL No. 391/101/0020

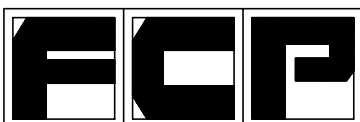

INDUSTRIES

Frankston Concrete Products

30-44 MILES GROVE

P.O.Box 306

SEAFORD, VICTORIA 3198

Tel.(03)9786 3111

Fax.(03)9786 3208

web site - [www.frankstonconcrete.com.au](http://www.frankstonconcrete.com.au)

email - [sales@frankstonconcrete.com.au](mailto:sales@frankstonconcrete.com.au)

DRAWN

M.D.S.

CHECKED

M.M.

APPROVED

C.Z.

DRAWING No.

95/1006B